

# TITANIUM VALVE LOCKS

Both, our newly designed **Radial Valve Locks** and **Square Valve Locks**, are made of premium Titanium alloy. The CNC-machined finish and the strict tolerances ensure a precise "lock" on the valve assembly. We offer them in the most popular applications.

Part N°	Specifications
<b>RADIAL VALVE LOCKS "SUPER 7°"</b>	
K11000	7 mm Std.
K11001	7 mm +.050
K11002	5/16 Std.
K11003	5/16 +.050
K11004	11/32 Std.
K11005	11/32 +.050
<b>SQUARE VALVE LOCKS "SUPER 7°"</b>	
K11006	5/16. Std.



# STEEL VALVE LOCKS

Part N°	Specifications
<b>VALVE LOCKS "SUPER 7°"</b>	
K10046	7 mm Std. Radial Groove
K10047	7 mm +.050. Radial Groove. Recess for lash caps
K10000	5/16 Std.
K10042	5/16 Std. Radial Groove
K10001	5/16 + .050
K10050	5/16 +.050. Recess for lash caps
K10043	5/16 +.050. Radial Groove. Recess for lash caps
K10003	11/32 Std.
K10044	11/32 Std. Radial Groove
K10004	11/32 + .050
K10045	11/32 +050. Radial Groove. Recess for lash caps
K10006	3/8 Std.
K10007	3/8 + .050
<b>VALVE LOCKS "7 DEG."</b>	
K10085	7 mm Std. Radial Groove
K10086	7 mm Std. Radial Groove. Shoulder Locks
K10016	5/16 Std.
K10058	.313 Std. Radial Groove. LS1, LS6, LS7 and L92
K10017	11/32 Std.
K10067	11/32. Radial Groove Std. Specially designed for <b>Ferrea Hollow Stem Valves Series</b>
K10018	3/8 Std.
<b>VALVE LOCKS "10 DEG."</b>	
K10009	5/16 Std.
K10041	5/16 Std. Recess for lash caps
K10010	5/16 + .050
K10039	5/16 Std. Radial Groove. Recess for lash caps
K10051	5/16 +.050. Recess for lash caps
K10040	5/16 +.050. Radial Groove. Recess for lash caps
K10011	11/32 Std. Recess for lash caps
K10012	11/32 + .050
K10033	11/32 Std. Radial Groove
K10038	11/32 +.050. Radial Groove. Recess for lash caps
K10014	3/8 Std.
K10015	3/8 + .050
K10032	3/8 Std. Recess for lash caps
<b>FORD 4.6L/5.7 - SOHC V8 - 24 VALVE - 2005-2007</b>	
K10077	.235", Radial Groove

## Ferrea

Valve Locks are manufactured from high quality 4140 chromoly bar stock and

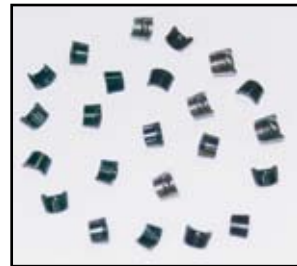

machined to exact tolerances. The locks are heat-treated for maximum strength and finished with black oxide for an attractive appearance. Our locks are available for Super 7°, 6°, 7° and 10° applications.

**New**

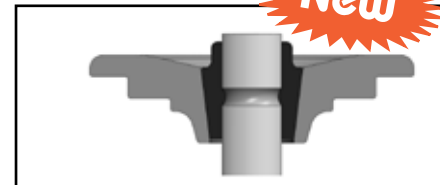

## Shoulder Valve Lock Design

Our newly designed radial valve locks feature a shoulder which provides extra material for support and protection for those high ratio rocker arm applications. The shoulder provides the stability needed at high RPMs reducing valve tip flex and fatigue.

Note: Shoulder locks can only be used on valves with a tip length of .250" or greater.



- Patent pending Hylomar technology
- Coated with non-setting sealant
- Our keepers stick to the valve stem
- Saves time & aggravation
- Standard & performance versions